

Pairing Your Earpiece

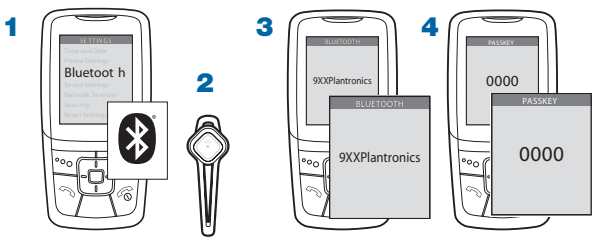

How to Pair Your Phone with Your Earpiece for the First Time

1 Turn on the Bluetooth feature on your phone.

For most phones, select Settings/Tools > Connections > Bluetooth > On. See your phone's user guide for more information.

2 Turn the earpiece on.

Press and hold the call control button until the indicator flashes red/blue. The earpiece is now in pairing mode.

If you don't see the red/blue flash, press and hold the call control button to turn your earpiece off, and then press and hold the call control button again until you see the red/blue flash.

3 Use the commands on your phone to locate your earpiece.

For most phones, select Settings/Tools > Connections > Bluetooth > Search > 9XXPlantronics. See your phone's user guide for more information.

4 When prompted for the PIN code or Passkey, enter 0000.

Pairing is successful when the indicator on your earpiece flashes blue. Your earpiece is now connected and ready to use.

For assistance call 1-800-HEADSETS (1-800-432-3738)