

PAIRING

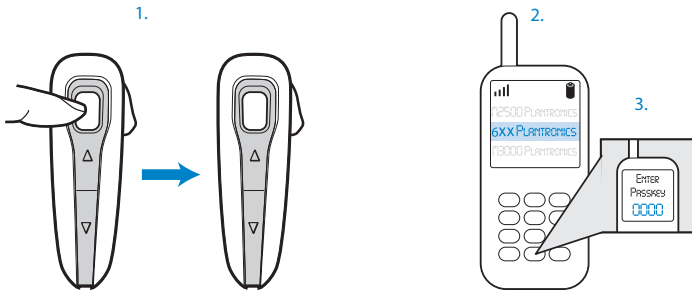

Before using your headset for the first time, you must pair it with your Bluetooth phone or device. Be sure the headset is fully charged. For set up and pairing instructions with Bluetooth devices other than mobile phones, please consult your Bluetooth device user guide.

Begin with headset turned off.

1. Press and hold down the call control button for 10 seconds until the headset status indicator begins to flash red then blue. The headset is now in pairing mode for the next 120 seconds.
2. While the headset is flashing, use the phone menu to search for Bluetooth devices and select "6xxPlantronics".
3. When prompted for a passkey, enter 0000. Headset will flash blue when paired successfully.

 **Headsets.com**
"America's Headset Specialists" SM
One Daniel Burnham Court, 400c
San Francisco, CA 94109

www.headsets.com